

waterpik® waterflosser®

QUICK START GUIDE

Model WF-03

1 Unit Prep (First time use only)

1. Remove reservoir

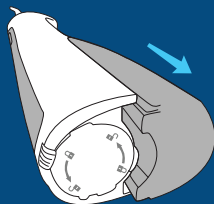

2. To remove battery door, twist, and pull.

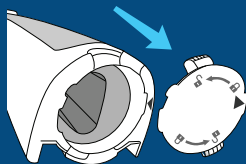

3. Insert 3 AA batteries. Included

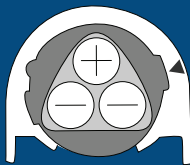

4. To replace battery door, line-up arrows, push and twist.

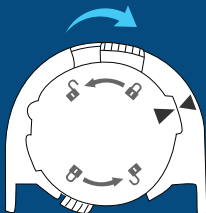

5. Insert tip firmly until it clicks into place.



6. Fill reservoir with warm water.

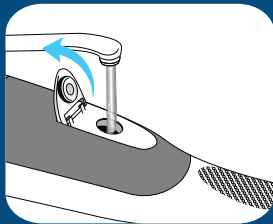

waterpik® waterflosser®

QUICK START GUIDE

Model WF-03

2 Water Floss

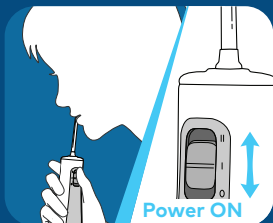

With water switch in OFF position, place tip in mouth. Slide power switch to low (I) position.



Lean over sink and close lips enough to prevent splashing, while still allowing water to flow from mouth into the sink.

3 Technique

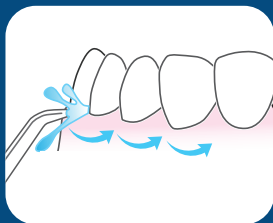

Aim water at the gumline at a 90 degree angle. Follow the gumline and pause briefly between teeth.

TO AVOID MESS: KEEP TIP IN MOUTH WHILE UNIT IS ON.